

# Ashraf Islam Engineering Building

Welcome Center | Room 104

Stonecipher Atrium | Room 126

Cybersecurity Education, Research & Outreach Center (CEROC) | Room 233  
(931) 372-3519 | [ceroc@tntech.edu](mailto:ceroc@tntech.edu) | [tntech.edu/ceroc](http://tntech.edu/ceroc)

College of Engineering, Office of the Dean | Room 325  
(931) 372-3172 | [engineering@tntech.edu](mailto:engineering@tntech.edu) | [tntech.edu/engineering](http://tntech.edu/engineering)

Electrochromic smart glass on the West side of the building uses a combination of predictive and real-time inputs via software and controls to manage daylight, glare, energy use and color rendition throughout the day.

A smart building structural dynamics sensing system outfitted with strain gauges and vibration sensors creates a global, non-intrusive building monitoring system for faculty and student research in structural dynamics and occupant/building interaction. An interdisciplinary team of civil and mechanical engineering faculty and students developed and placed the system during construction, creating a valuable teaching and research platform.

The pond on the west side of building provides a living water laboratory for environmental study of groundwater for use by environmental engineering students, biology students and others by harnessing Tech's natural water resources. A biological and chemical lab inside the building creates a full laboratory ecosystem for the study of water.



## First Floor

- 1 Broadwater Terrace | Terrace
- 2 Koltowich Outdoor Environmental Laboratory | Pond
- 3 Stonecipher Atrium | Room 126
- 4 Welcome Center | Room 104
- 5 Flexible Lab Environment for Experimentation and Testing (FLEET) | Room 105
- 6 Phillips Lab - Vehicle Engineering Lab | Room 116
- 7 Flex Lab | Room 122
- 8 Gower Lab - Adaptive Learning Lab | Room 130
- 9 Intelligent Machines & Autonomous Systems Lab | Room 143
- 10 Vehicle Systems Learning Lab | Room 147
- 11 Albright Lab - AR/VR Lab | Room 148
- 12 Koltowich Lab - Automotive Design Lab | Room 178
- 13 Koltowich Lab - Automotive Design Lab | Room 179
- 14 Jones Lab - Student Projects Lab | Room 181

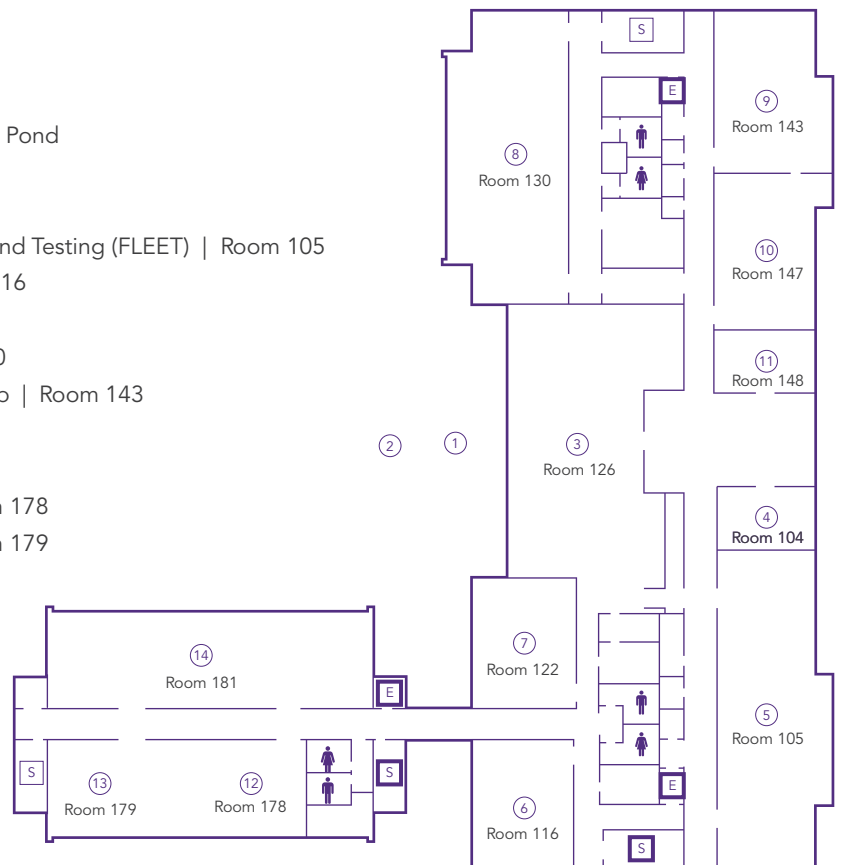

# Second Floor

- 15 CEROC Cyber Training Lab | Room 203
- 16 Vanhooser Room - Collaboration Room | Room 205
- 17 CEROC Cyber Innovation Lab | Room 206
- 18 CEROC Undergraduate Student Lab | Room 209
- 19 CEROC Lounge | Room 212
- 20 CEROC Graduate Lab | Room 218
- 21 **Mitchell Suite - CEROC Offices | Room 233**
- 22 Patterson Place - Collaboration Room | Room 237
- 23 Carlen Room - Collaboration Room | Room 238
- 24 Harold Ray Sells Room - Collaboration Room | Room 242
- 25 Adaptive Learning Lab | Room 244
- 26 Adaptive Learning Lab | Room 249
- 27 Campbell Room - Collaboration Room | Room 253
- 28 Agile Programming Lab | Room 255
- 29 Programming Lab | Room 256
- 30 Programming Lab | Room 260
- 31 Lowry Room - Collaboration Room | Room 261
- 32 Tutoring Lab | Room 262
- 33 ACE Room - Collaboration Room | Room 273
- 34 Design & Computation Studio | Room 276
- 35 Student Projects Fabrication Lab | Room 277

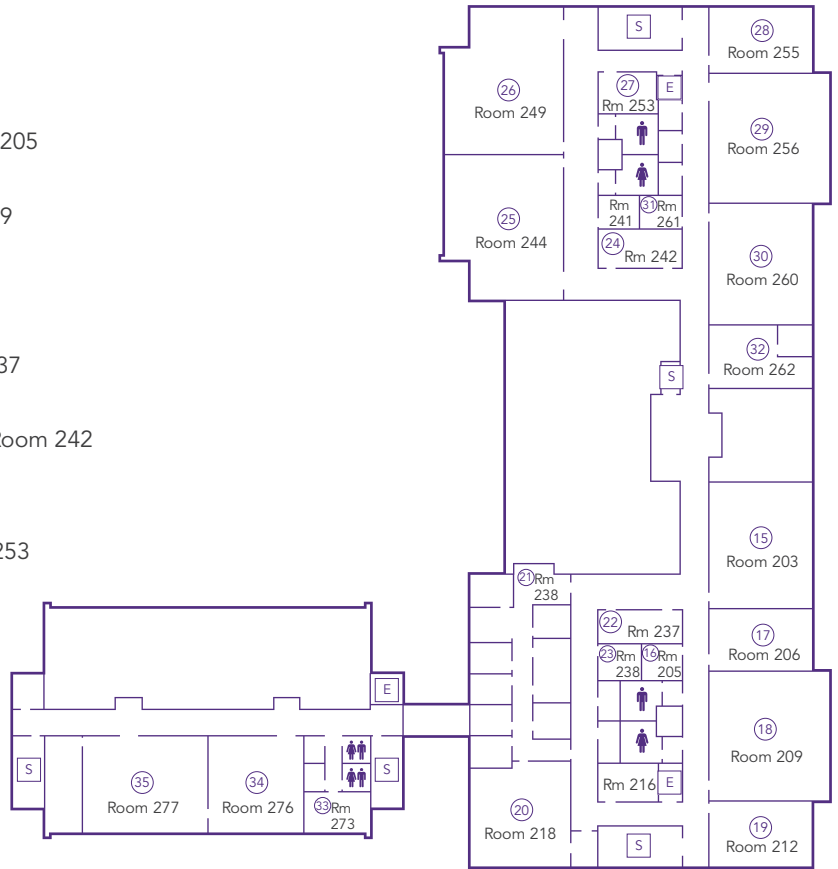

# Third Floor

- 36 Hydraulics Lab | Room 303
- 37 Chemical, Biological & Environmental Lab | Room 305
- 38 **Faculty Office Suite | Room 311**
- 39 F.R. Toline Room - Collaboration Room | Room 314
- 40 Thomas M. Hudson Room - Collaboration Room | Room 317
- 41 **Shen Suite - Office of the Dean | Room 325**
- 42 Tate Family Conference Room | Room 345
- 43 Stoppenhagen Room A - Collaboration Room | Room 352
- 44 Darcy Lab - Adaptive Learning Lab | Room 354
- 45 Larsen Room - Collaboration Room | Room 355
- 46 Chow Lab - Adaptive Learning Lab | Room 361
- 47 Chisolm Enclave - Collaboration Area | Room 363
- 48 Anderson Family Room - Collaboration Room | Room 367
- 49 Carter Lab - Measurements, Instrumentation & Circuits Lab | Room 368
- 50 Hutsell Room - Collaboration Room | Room 374
- 51 Stoppenhagen Room B - Collaboration Room | Room 376
- 52 Mechatronics and Controls Lab | Room 377

